

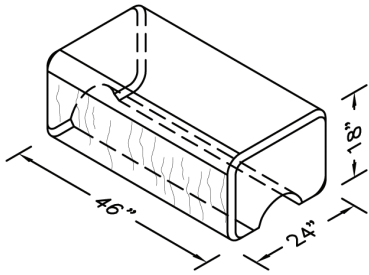

REDI-ROCK BLOCK SPECIFICATIONS: FREE STANDING STANDARD BLOCKS

FULL

6" CAP BLOCK



**FREE STANDING
TOP BLOCK**
CODE: RW-RR-FS-TB-F
LC: TBF
1600 LBS

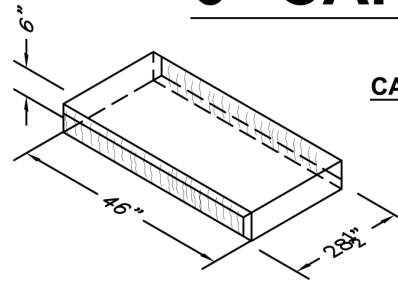

CAP BLOCK (TWO SIDED)
CODE: RW-RR-FS-CAP2SIDED
LC: 2C
600 LBS

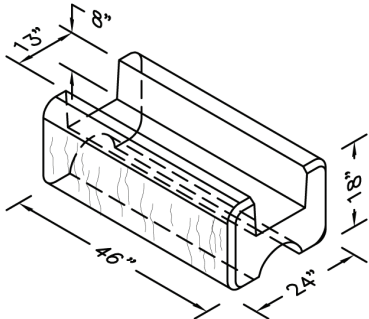

**FREE STANDING
TOP BLOCK
(46" X 13" X 8"
DEEP GARDEN)**
CODE: RW-RR-FS-TG-F
LC: TGF
1200 LBS

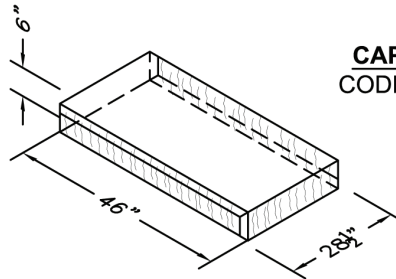

CAP BLOCK (THREE SIDED)
CODE: RW-RR-FS-CAP3SIDED
LC: 3C
600 LBS

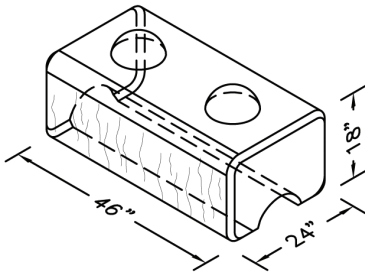

**FREE STANDING
MIDDLE BLOCK**
CODE: RW-RR-FS-MB-F
LC: MBF
1650 LBS

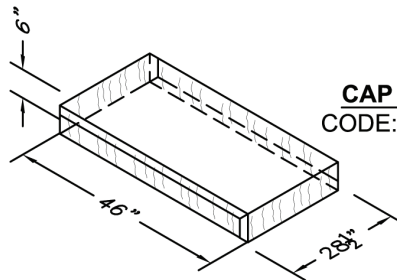

CAP BLOCK (FOUR SIDED)
CODE: RW-RR-FS-CAP4SIDED
LC: 4C
600 LBS

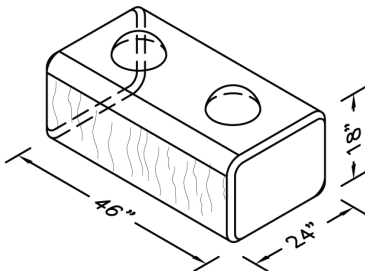

**FREE STANDING
BOTTOM BLOCK**
CODE: RW-RR-FS-BB-F
LC: BBF
1700 LBS

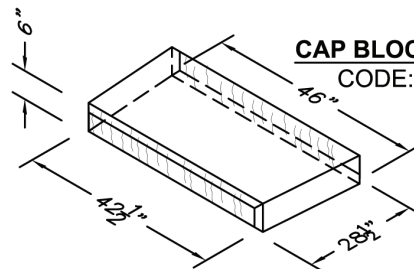

CAP BLOCK (TWO SIDED CURVE)
CODE: RW-RR-FS-CAP-SP
LC: 5C
600 LBS

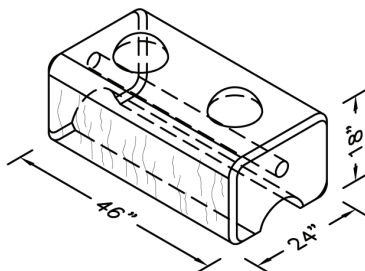

**FREE STANDING
MIDDLE BLOCK
(3" DIA.
HORIZONTAL TUBE)**
CODE: RW-RR-FS-MB-HT
LC: MBH
1500 LBS

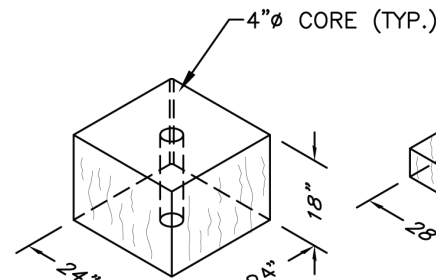

**COLUMN BLOCK
(LIMESTONE FINISH)**

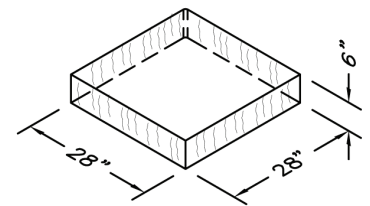

**COLUMN CAP BLOCK
(4-SIDED)**